

Scale SSB



Description

SSB is a low profile platform scale designed for weighing on the ground. Its technical characteristics allow it to be used in all industrial sectors.

Characteristics

- ▶ It is composed of :
 - An extra flat platform 55 mm high, equipped with four load cells IP67 or IP68 nickel plated (depending on model)
 - Optional stainless steel load cells
 - A ramp fixed on one side of the scale
- ▶ Supplied with a 6 meter cable
- ▶ Compatible with all the weighing indicator range of Arpege Master K or any other compatible indicators
- ▶ Available in alloy or stainless steel versions

| Version | Dimensions available (mm) | Scope / Echelon |
|---------|---------------------------|---|
| Steel | 800 x 800 | 150 kg / 50 g ^A 300 kg / 100 g ^B 600 kg / 200 g |
| | 1 000 x 1 000 | 300 kg / 100 g 600 kg / 200 g 1 500 kg / 500 g |
| | 1 000 x 1 250 | 600 kg / 200 g 1 500 kg / 500 g |
| | 1 250 x 1 000 | 600 kg / 200 g 1 500 kg / 500 g |
| | 1 250 x 1 250 | 600 kg / 200 g 1 500 kg / 500 g |
| | 1 250 x 1 500 | 600 kg / 200 g 1 500 kg / 500 g |
| | 1 500 x 1 250 | 600 kg / 200 g 1 500 kg / 500 g |
| | 1 500 x 1 500 | 1 500 kg / 500 g |

| Version | Dimensions available (mm) | Scope / Echelon |
|-----------------|---------------------------|---|
| Stainless steel | 800 x 800 | 150 kg / 50 g ^A 300 kg / 100 g ^B 600 kg / 200 g |
| | 1 000 x 1 000 | 300 kg / 100 g 600 kg / 200 g 1 500 kg / 500 g |
| | 1 000 x 1 250 | 600 kg / 200 g 1 500 kg / 500 g |
| | 1 250 x 1 000 | 600 kg / 200 g 1 500 kg / 500 g |
| | 1 250 x 1 250 | 600 kg / 200 g 1 500 kg / 500 g |
| | 1 250 x 1 500 | 600 kg / 200 g 1 500 kg / 500 g |
| | 1 500 x 1 250 | 600 kg / 200 g 1 500 kg / 500 g |
| | 1 500 x 1 500 | 1 500 kg / 500 g |

^A Not available in legal-for-trade version

^B Legal-for-trade version only with IDe indicator range

Dimensions

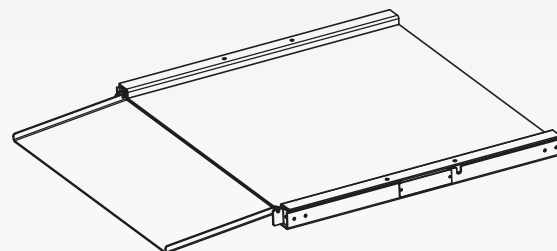
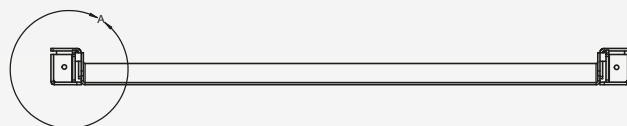
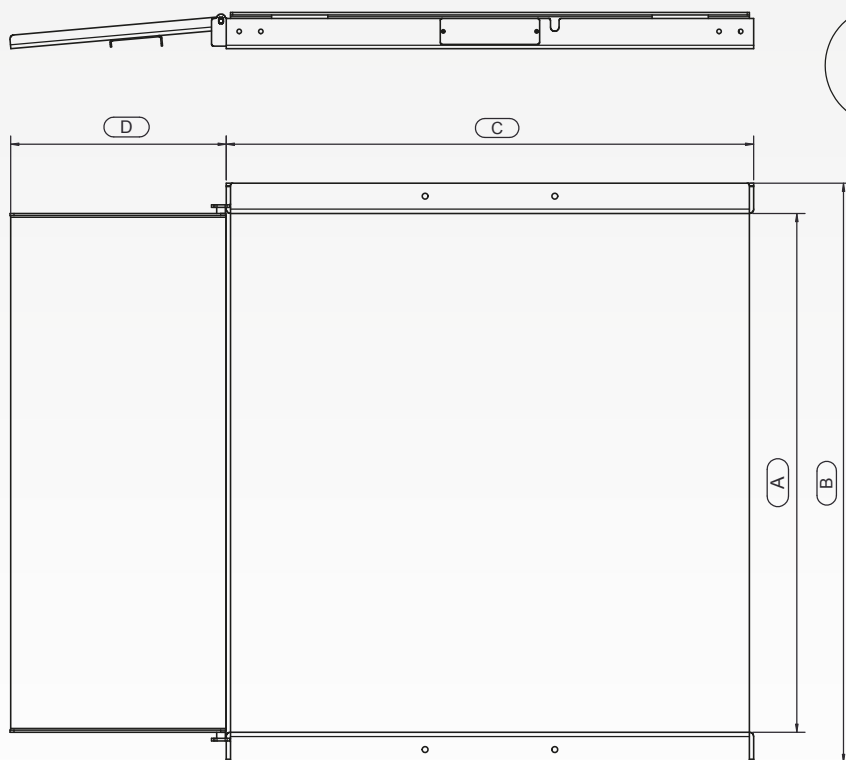

| Available dimensions (in mm) | | | | | |
|------------------------------|------|------|-----|----|----|
| A | B | C | D | E | F |
| 800 | 996 | 800 | 500 | 55 | 97 |
| 1000 | 1196 | 1000 | | | |
| 1000 | 1196 | 1250 | | | |
| 1250 | 1446 | 1000 | | | |
| 1250 | 1446 | 1250 | | | |
| 1250 | 1446 | 1500 | | | |
| 1500 | 1696 | 1250 | | | |
| 1500 | 1696 | 1500 | | | |

RETAIL A
SCALE 1 : 3

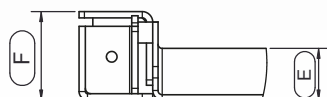

Dimensions in mm

OptionsS

- ▶ Second ramp (stainless or alloy steel), length of 500 mm, in opposite side to the first ramp
- ▶ Available widths: 800, 1000, 1250 or 1500 mm
- ▶ Stainless steel load cells instead of nickel plated versions

ARPEGE MASTERK

Bâtiment n°6 - 15, rue du Dauphiné
CS 40216 - 69808 St PRIEST - FRANCE
Tél : +33 (0)4 72 22 92 22
Fax : +33 (0)4 72 22 93 45
marketing@masterk.com

Company Registration: 971 506 480 RCS LYON
SIC registration code: APE 2829A French VAT: FR 28 971 506 480

Our product factsheets
are available for download
from our website
www.masterk.com

Your contact information